

# Processing example: pressure retention valve

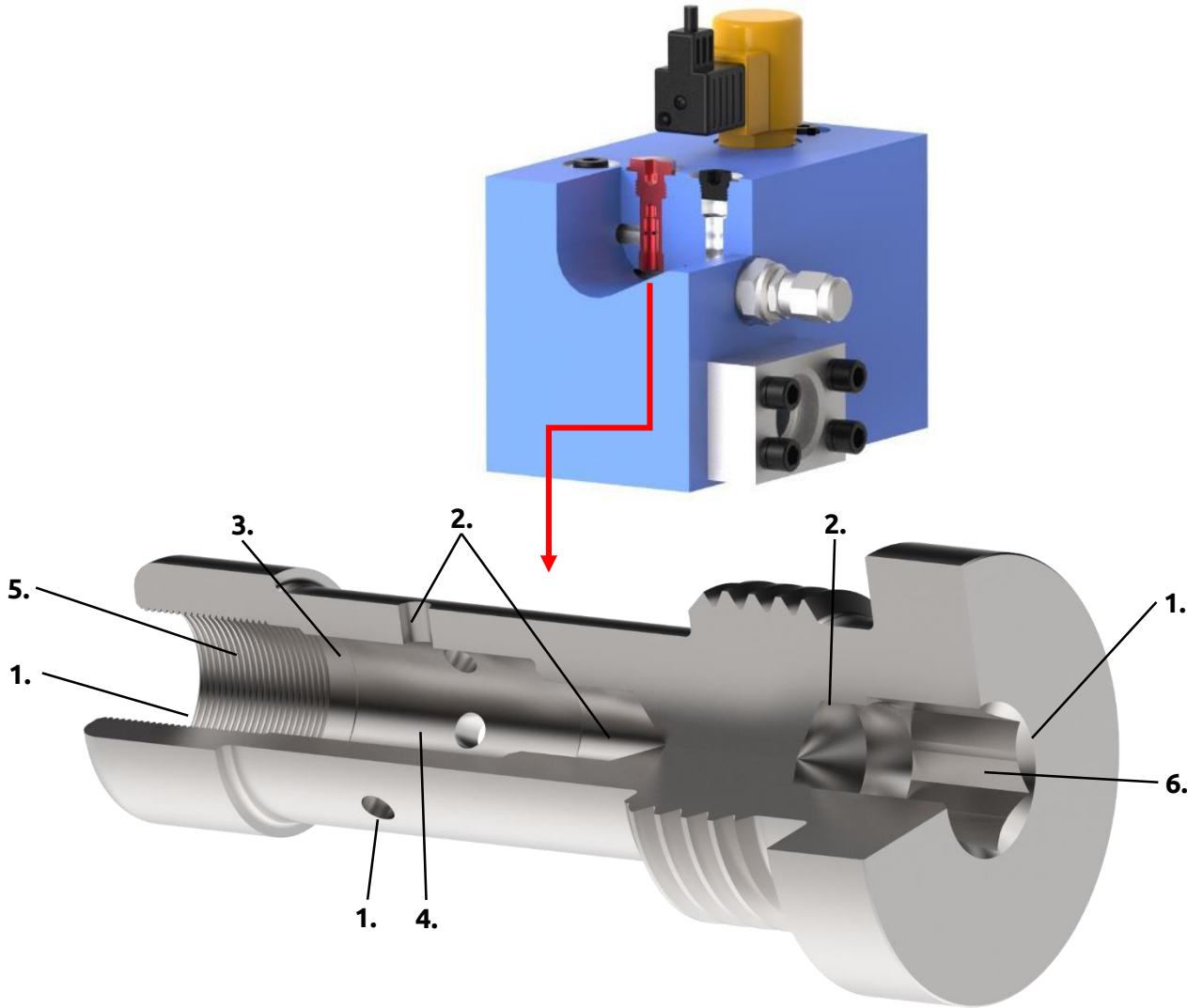

1. DRP - centering pointer

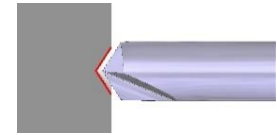

2. DRA - high performance chamfering drill

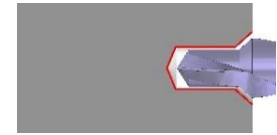

3. SDG - boring bar

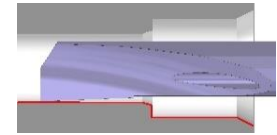

4. DRE - precision reamer or stepped reamer

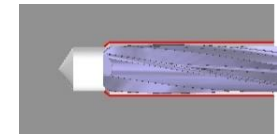

5. SDU/SDV - threading cutter-partial and solid profile

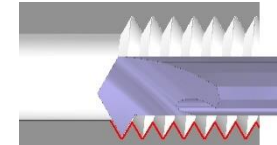

6. BRH - broaching tool

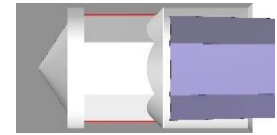

7. Tools for manufacturing of special profiles to customer specification

